

BF Model Dust Collection System; It is used in the collection of dust emitted to the environment during product discharge. It is designed to achieve the highest efficiency according to the type of dust.

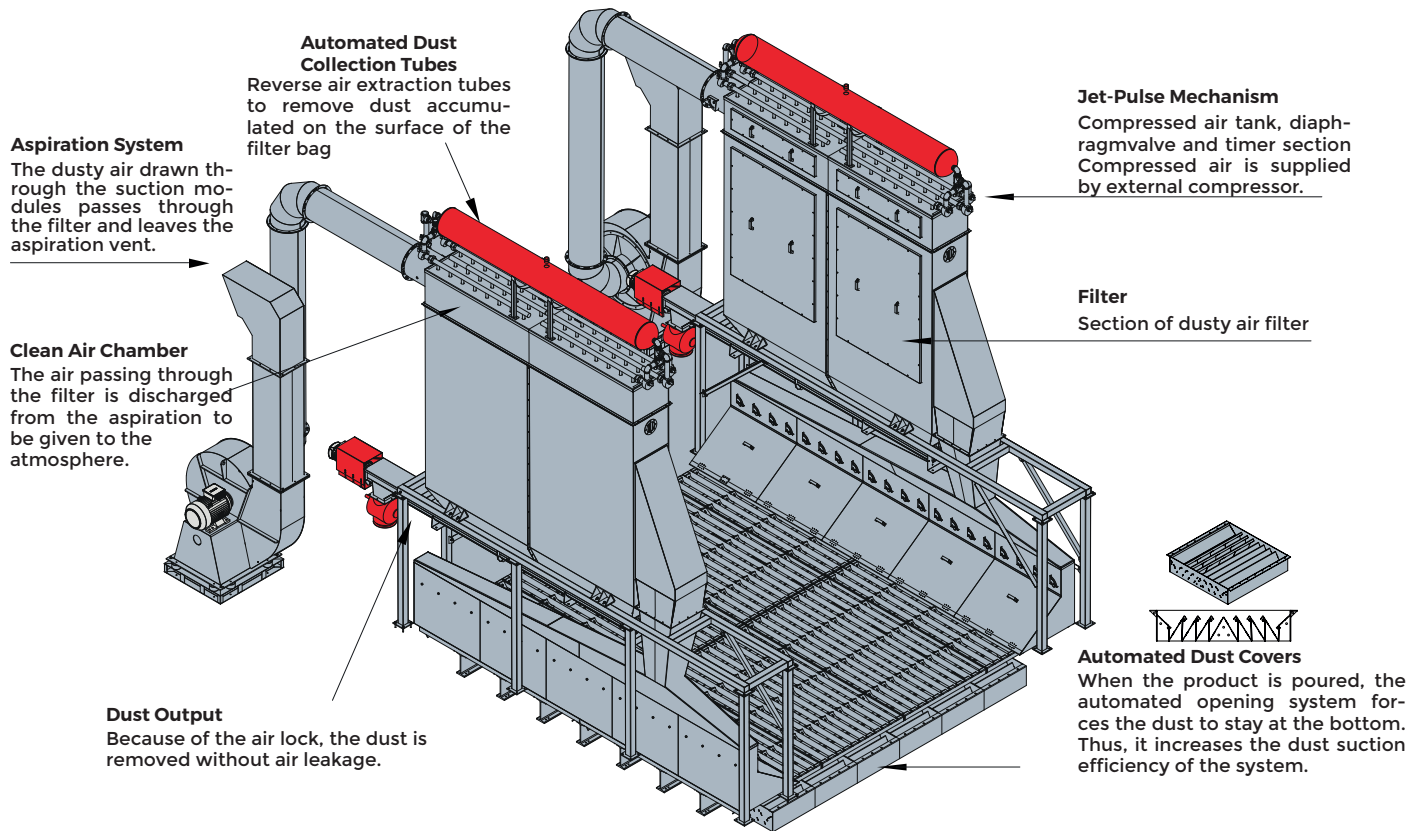

## PRODUCT FEATURES

The grain product that is unloaded into the intake pit flows to the inner part of the intake by passing through the grating and special dust-proof covers respectively. The dust, formed during this time, tends to move upwards. Only the covers with product flow are opened in the specially designed embedded intake cover system, and the dust cannot go upwards as there is product flow on this part. As soon as the product flow is interrupted, the cover will be closed by gravity.

Thanks to the suction fans, dust is drawn to the filter panels and collection is ensured. Dust is accumulated in the filters at the top. Instant cleaning of accumulated dusts is provided by using Jet-Pulse technique. The auger under the panel removes the collected dust from the system. The collected dust can be poured to the intake again or bagged from the outlet of the airlock, optionally

### STANDARD EQUIPMENTS:

- Time Controlled Filter Cleaning System
- Polyester Filter Bags
- Filter Cleaning Valves
- Aspiration system

### OPTIONAL EQUIPMENTS:

- ATEX equipment for explosive dusts
- Air Lock
- Piping System

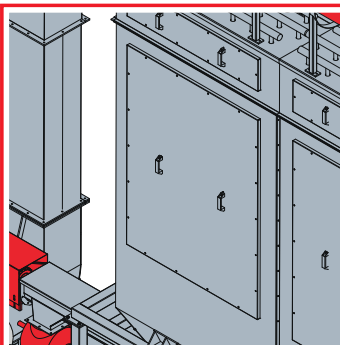

Filter Access Covers

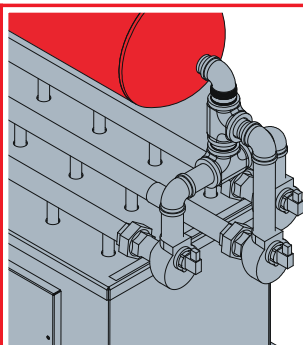

Automated Filter Cleaning

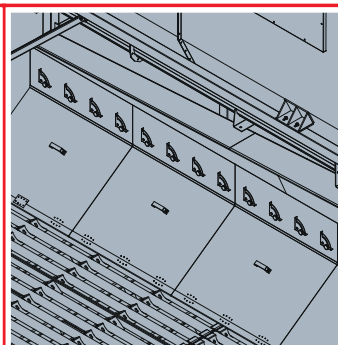

Adjustable Dust Section Module

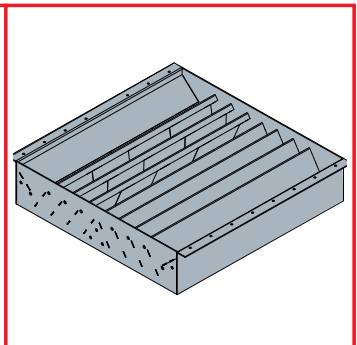

Automated Dust Covers

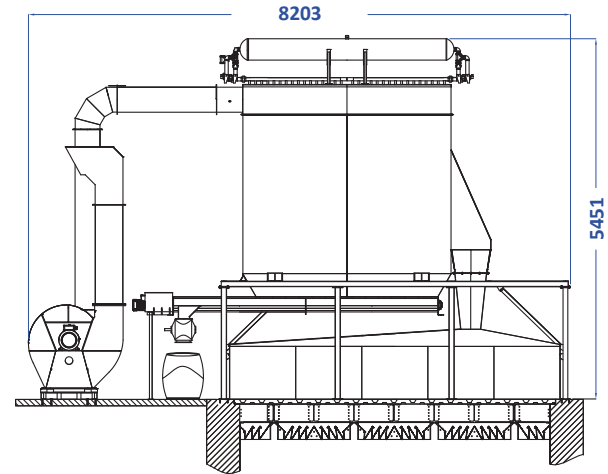
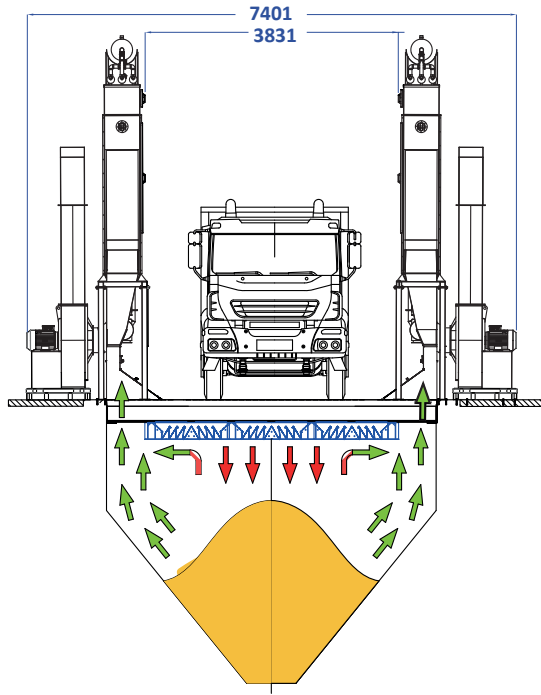

#### Automated Dust Covers ;

1. The grain product that is unloaded from the truck, flows to the inner part of the bunker by passing through the grating and special dust-proof covers respectively.
2. The dust, formed during this time, tends to move upwards.
3. Only the covers with product flow are opened in the specially designed embedded intake cover system, and the dust cannot go upwards as there is product flow on this part.
4. The aspiration fans draws the dust to the side panels to collect it.
5. The dusty air directed to the jet filter section at the top is discharged from the aspiration vent after being filtered.

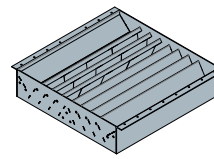

Dust Retaining Cover

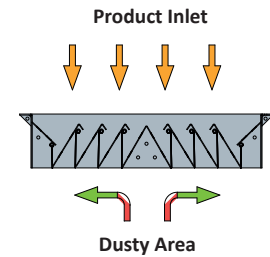

Dusty Area

### Technical Specification

Brand	Mysilo
Model	DC-BF
Number of Bag / Diameter (mm)	96/160
Total Filter Area (m²)	102
Number of Pulse and Connection Dimension	12/(1-1/2")
U Auger Dimensions ( mm )	2 x 165x3.000
Aspirator (kW)	2 x 11 kW 1.500 rpm
Air Tank ( lt )	2 x 315
Air Requirement (lt / min)	1.500

\* General dimensions.

\* Mysilo has the right to change the technical specifications.